

Expansion Joint Systems

Quick Reference Guide

Interior Floors

" = Joint Opening % = Movement Capability

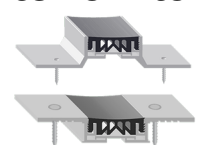

7500 Series (75F)

1" - 2"
+/-25%



No-Bump Series (NB, NBR)

1" - 12"
+/-50% to 100%*
Various recess depths available
Stainless Steel plate option*
Seismic*

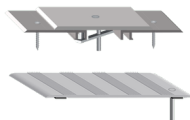

Surface-Mounted (EXF, EXBF, RPA, BHS)

2" - 6"
+/-50% to 100%*
Seismic*

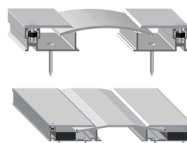

6000 Series (6F)

2" - 8" (Larger available)
+/-50% to 100%*
Stainless Steel plate option*
Options with grooved, tile, abrasive, carpet, smooth



Deep Recess Series (PS, PSF)

4" - 16" (Larger available)*
+/-50% to 100%



Heavy Duty (HDNB)

4" - 8"
+/-50% only



Heavy Duty (XH4FS)

1" - 6"
+/-50% to 100%



Minimal Sightline Carpet (BCP)

2"
+/-50%



Gymnasium Series (1420, 1120)

Floor-to-Floor only
1" - 2"
+/-50% only



Gymnasium Series (G)

2"
+/-50% to 100%
Surface-Mounted

Interior Walls & Ceilings

" = Joint Opening % = Movement Capability



7500 Series (75F)

1" - 2"
+/-25% Only



Metal Series (CM, FC)

3" - 12"
+/-50% to 100%



Snap-on Series (WD)

1" - 4"
+/-50%
Stainless Steel Laminate option*

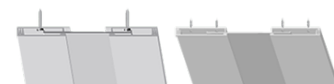

6000 Series (6GW, 6TW)

1" - 8"
+/-50% to 100%*
Recess depths 5/8" & 1/2"
Stainless Steel plate option*
Seismic

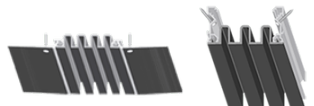

Interior Variable (TCVS, GCVS)

Wall only
2" - 16"
+/-100%
Santoprene or Silicone*
Seismic

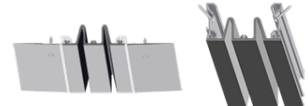

Interior Flat (TCWW, GCWW)

Wall only
2" - 16"
+/-50%
Santoprene or Silicone*
Seismic*

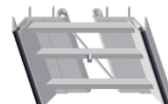

Deep Recess Series (PSW)

4" - 16"
+/-50% to 100%



Rizza Interior (IS)

2" - 12"
+/-50%
Silicone only
Seismic*

Exterior Floor

" = Joint Opening % = Movement Capability



Blockout Parking Series (SBP, SWPQ, SMPQ)

2" - 12"*
+/-50% to 100%*
Seismic*



Surface-Mounted Parking (DFH, SM)

4" - 18"*
+/-50% to 100%*
Heavy duty

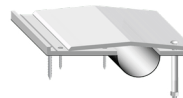

Metal Parking Series (HPG)

2" - 12"
+/-50% to 100%
Heavy duty
Retro-fit available

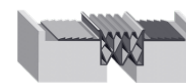

Winged Chambered Seal

1.5" - 3"
+/-50% only*
Elastomeric
Seismic*



Split Slab Dual- & Multi-Chambered Seal (SSPD)

2.5" - 3.5"
+/-50% only*
Elastomeric
Seismic*
Cover plate option available

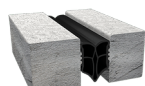

Epoxy Bonded Seal (ES)

1" - 3"
+/-50% only*
Elastomeric
Seismic*



Flex Seal (FS)

.8125" - 3.25"
+/-50% only*
Elastomeric
Seismic*



Pre-Compressed Foam Seal (BCSF-SL)

0.5" - 6"
+/-50% only
Can be used for interior
(3" & up requires cover plate)

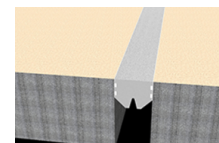

Non Pre-Compressed Foam Seal (BHFE)

0.5" - 6"
+/-25% only
Can be used for interior

*Not every option within the series is necessarily available. Larger widths available for many systems. See full catalog or contact a representative for details. Water and Fire Barriers available for most. Corner options available for most.

Expansion Joint Systems

Quick Reference Guide

Exterior Wall

" = Joint Opening % = Movement Capability

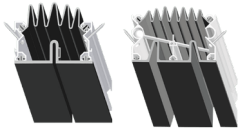

Exterior Flat (FCWW)
2" - 18"*
+/-50%
Santoprene or Silicone*
Seismic*

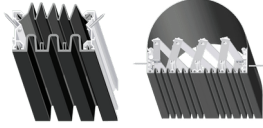

Exterior Variable (FCVS)
2" - 16"* (Larger available)
+/-100%*
Santoprene or Silicone*
Seismic*



Surface-Mounted (CMX)
3" - 18"
+/-50% to 100%
Low Profile
Seismic*

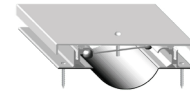

Surface-Mounted (9W)
1" - 18"
+/-50% to 100%
Stainless Steel plate option*
Seismic*

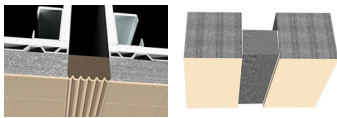

Pre-compressed Foam Seal (BCSW, BVSW, BBSW)
0.5" - 6"*
+/-25% to 50%
Can be used for interior

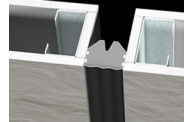

Non Pre-compressed Foam Seal (BCSWE)
1" - 6"
+/-25% only
Can be used for interior

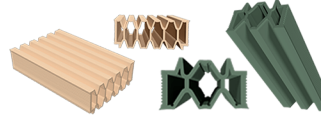

Rizza Compression Series (CE)
1" - 4"
+/-37%
Silicone only
Can be used for interior
Seismic



Rizza Exterior (EV)
2" - 12"
+/-50% only
Silicone only
Seismic*

Exterior Roof

" = Joint Opening % = Movement Capability

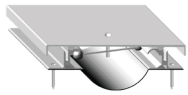

Surface-Mounted Roof (9W)
1" - 18"
+/-50% to 100%
Stainless Steel plate option*
Seismic*

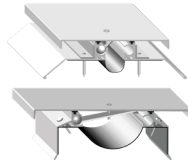

Roof Metal (LPR, FR)
1" - 18"*
+/-50% to 100%
Stainless Steel plate option*
Seismic

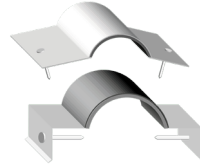

Roof Bellow (BRB)
Straight or Curb
1" - 10"*
+/-50% to 100%
Options of galvanized,
copper, stainless steel,
& aluminum flanges



Rizza Roof (RR/RW)
2" - 10"*
+/-50% only
Silicone only
Seismic*

Fire Barriers

" = Joint Opening % = Movement Capability

Floor

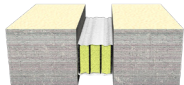

MetaBlock® (MBF)
Available in 2Hr, 3Hr, & 4Hr
1.25" - 6"*
+/-25% to 50%



MetaMat™ (MF)
Available in 2Hr
1" - 6"
+/-33% to 100%



MetaFlex® 2000 (2HFFB)
Available in 2Hr
8" - 24"
+/-50% to 100%



FR Precompressed (FRBCSF)
Available in 2Hr & 3Hr
1.5" - 4.5"
+/-25% to 50%*

Wall/Ceiling

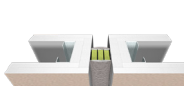

MetaBlock® (MBW)
Available in 2Hr, 3Hr, & 4Hr
Gypsum/Concrete
1.25" - 4.5"*
+/-25% to 50%

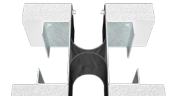

MetaMat™ (MW)
Available in 2Hr
1" - 6"
+/-33% to 100%

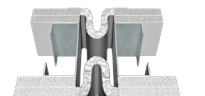

MetaFlex® 2000 (2HWFB)
Available in 2Hr
8" - 24"
+/-50% to 100%



FR Precompressed (FRBCSW)
Available in 2Hr & 3Hr
Gypsum/Concrete
1" - 4.5"
+/-25% to 50%*

Acoustical Ceiling

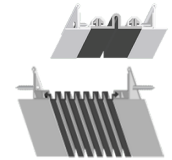

Suspended Series (ACWW, AC)
Ceiling only
1" - 10"*
+/-50%
Seismic*

*Not every option within the series is necessarily available. Larger widths available for many systems. See full catalog or contact a representative for details. Water and Fire Barriers available for most. Corner options available for most.